



SAFETY INSTRUCTIONS

Before installation and operation, read these instructions carefully and use this product only in the manner described by the manufacturer in the operation manual. The instruction shown below are used to alert you to potential personal injury and property damage hazards. There are three hazard classifications based on potentially dangerous situations. Obey all safety instructions that show these symbols to avoid possible injury, death and property damage.

WARNING: WARNING indicates a potentially hazardous situation which, if not avoided, could result in death or serious injury.

CAUTION: CAUTION indicates a potentially hazardous situation which, if not avoided, may result in minor or moderate injury.

CAUTION: CAUTION used without the safety alert symbol indicates a potentially hazardous situation which, if not avoided, may result in property damage.

NOTE: The safety instructions are explained with the following pictographic symbols.

means prohibition. It indicates actions, if any, that mustn't be done.
 means forcible execution. It indicates actions, if any, that must be done.

WARNING

- TO REDUCE THE RISK OF FIRE, ELECTRIC SHOCK, OR INJURY TO PERSONS, OBSERVE THE FOLLOWING:
 - Use this unit only in the manner intended by the manufacturer. If you have questions, contact the manufacturer.
 - Before servicing or cleaning unit, switch power off at service panel and lock the service disconnecting means to prevent power from being switched on accidentally. When the service disconnecting means cannot be locked, securely fasten a prominent warning device, such as a tag, to the service panel.
- To reduce the risk of fire or electric shock, do not use this product with any solid-state speed control device.
- TO REDUCE THE RISK OF FIRE, ELECTRIC SHOCK, OR INJURY TO PERSONS, OBSERVE THE FOLLOWING:
 - Installation work and electrical wiring must be done by a qualified person(s) in accordance with all applicable codes and standards, including fire-rated construction.

- Sufficient air is needed for proper combustion and exhausting of gases through the flue (chimney) of fuel burning equipment to prevent back drafting. Follow the heating equipment manufacturer's guidelines and safety standards such as those published by the National Fire Protection Association (NFPA), and The American Society for Heating, Refrigeration and Air Conditioning Engineers (ASHRAE), and the local code authorities.
 - When cutting or drilling into wall or ceiling, do not damage electrical wiring and other hidden utilities. Ducted fans must always be vented to the outdoors.
 - This unit is designed for ducted or ductless installation. When ductless kit part numbers FDK-06A is installed, this unit is certified ductless. The end user is responsible to ensure compliance with all Federal, State and Local Environmental and Fire codes.
- TO REDUCE THE RISK OF FIRE, USE ONLY METAL DUCTWORK.
 - This unit must be grounded.
 - Install this range hood to a liner. Check that the hood is correctly installed, since incorrect installation could result in the range hood becoming detached and falling off.
 - Connect only to an AC120 Volt power source or the range hood could result in fire, electric shock, and damage.

CAUTION

- For general ventilating use only. Do not use to exhaust hazardous or explosive material and vapors.
- To reduce the risk of fire and to properly exhaust air, be sure to duct air outside. Do not vent exhaust air into spaces within walls or ceilings or into attics, crawl spaces, or garages.
- Read specification label on this product for further information and requirements.
- Use only for the purpose of kitchen ventilation.
- Do not install this range hood in the bathroom or in other wet rooms since electrical shock and damage may result.
- Fasten the filter and other parts securely. Incorrect attachment may result in personal injury or property damage.
- Keep your hands and other objects away from the fan while it is in motion. The range hood may injure you or damage itself.

NAMES OF PARTS

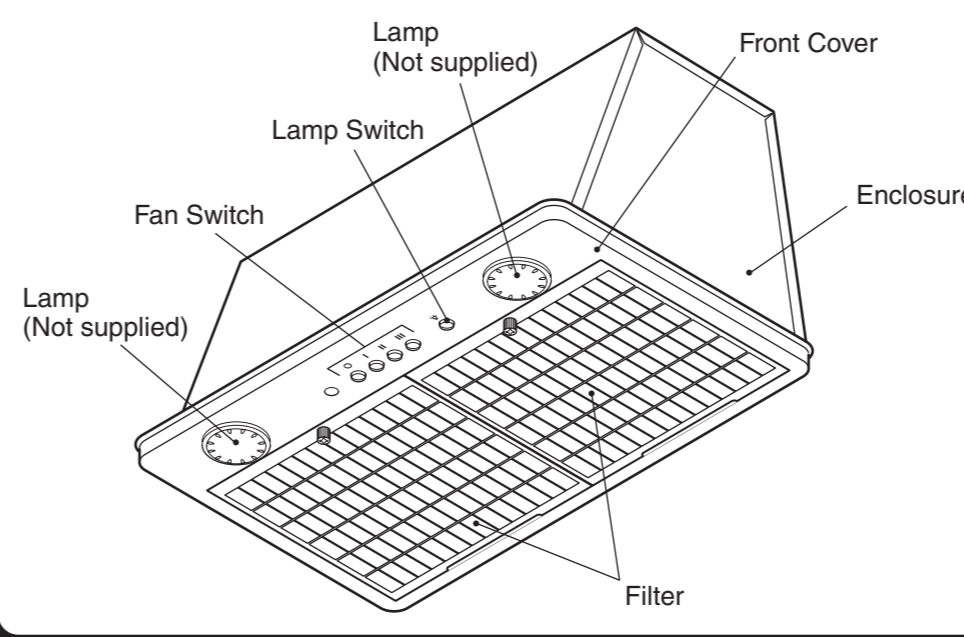

CIRCUIT DIAGRAM

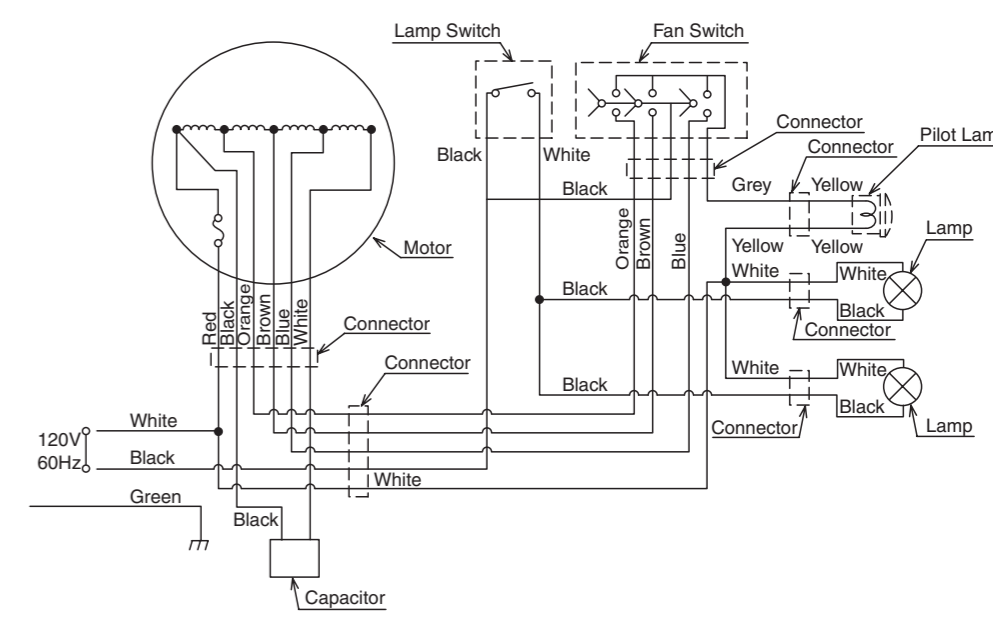

DIMENSIONS

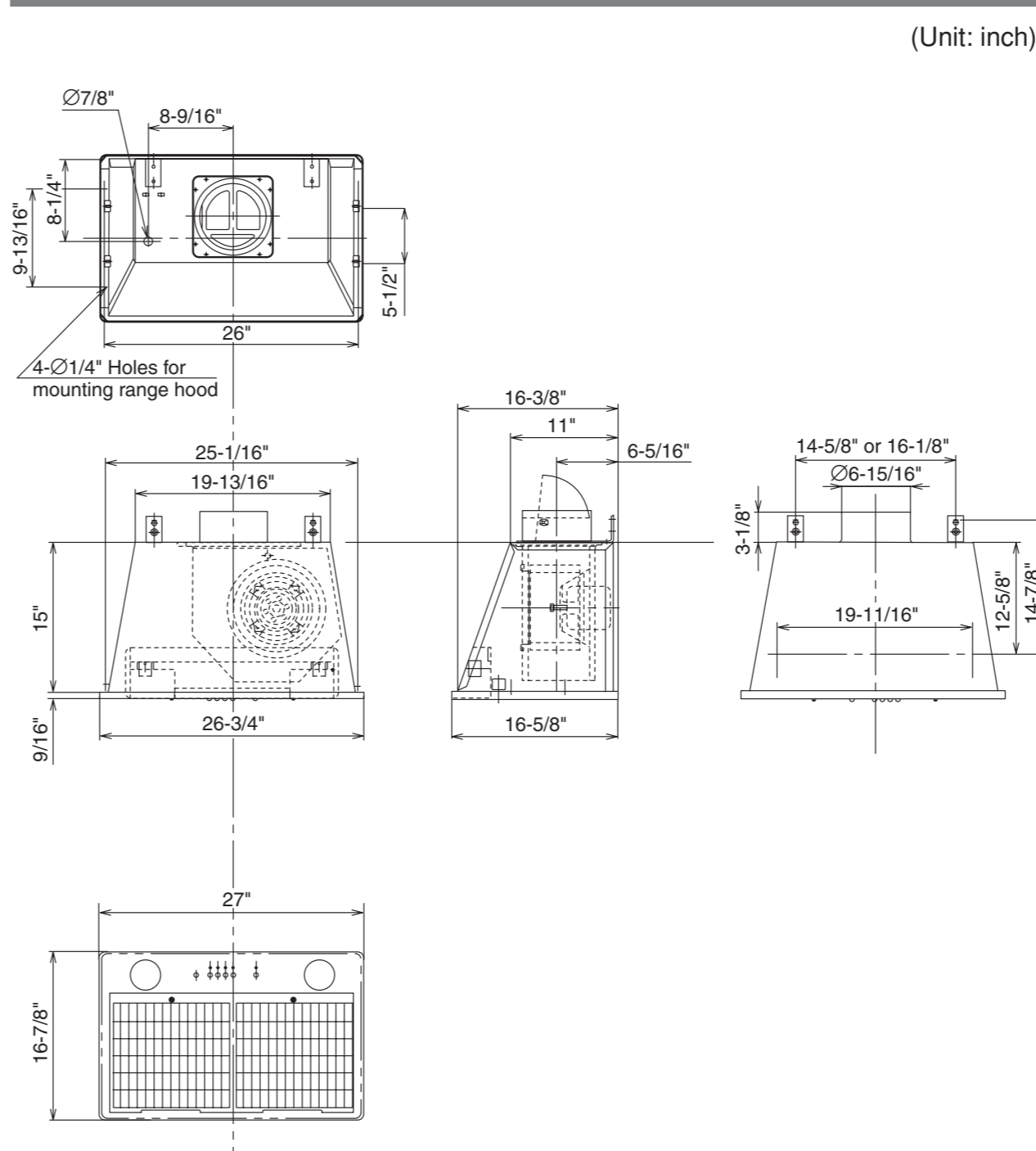

ACCESSORIES

- Screw M5.1x45 Four (4) pieces
- Screw M4.5x45 Two (2) pieces
- Screw M5x30 Four (4) pieces
- Nut with plate Four (4) pieces

RANGE HOOD LOCATION

- The range hood must be installed just above the cooktop.
 - The minimum distance from the cooking surface to the bottom of the range hood must be 24".
 - The total weight of the BUF-06W range hood unit is 35.2 lbs. (16 kg)
 - Power requirements are: AC120 V, 60 Hz, 3.0 Amp
- WARNING:** Check that the hood is correctly installed, since incorrect installation could result in the detachment of the range hood and the unit could fall.
- CAUTION:** To protect hands from injury, wear working gloves when installing the range hood.

INSTALLATION

1. Preparation

WARNING: If the range hood is not installed properly, it could become detached and fall. Ensure that the metal duct does not touch other metal housing materials, otherwise fire or electric shock could result.

1 According to the conditions where the range hood is installed, determine whether it will be discharged vertically or horizontally (7" round duct). For vertical or horizontal discharge, run duct work between the hood location and the roof cap or wall cap. For best result in either direction, use a minimum number of transitions and elbows. Be sure to attach a roof cap or wall cap to avoid rain/wind entry.

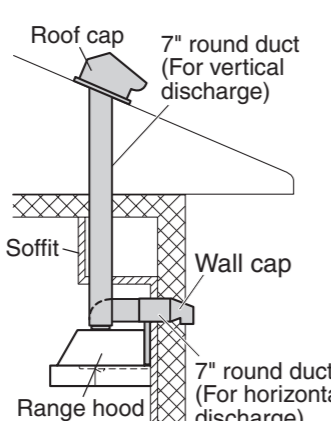

2 The range hood unit must be mounted to a liner which has the following dimensions. Install the liner securely after checking that the opening size of the liner is the same as the figure right.

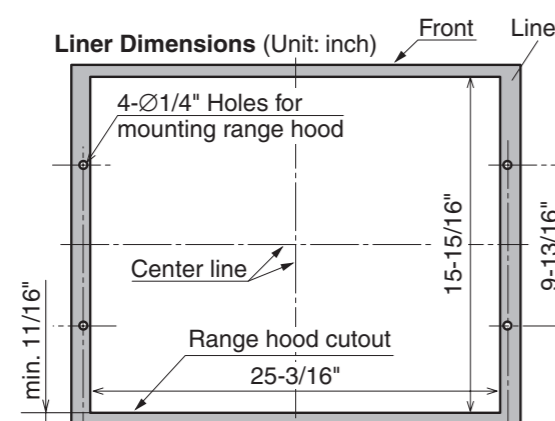

CAUTION: The liner shape illustrated in this installation manual is only for reference.

CAUTION: When the liner is installed in the wooden hood, the inside of the wooden hood placed above the cooking surface must be fully covered by the metal barrier including bottom edges. Select a suitable liner and metal barrier according to the size and shape of the wooden hood and install properly. The liner should be installed tightly. If the liner installation is not correct, the range hood unit may become detached and fall.

3 Make sure that a 3/4" thickness wood panel for mounting the range hood is fixed on the wall where the range hood is installed. **Note:** If no wood panel is found on the wall, be sure to prepare one referring to the figure.

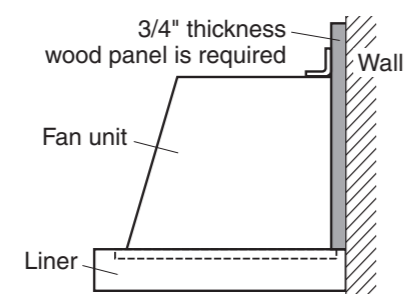

4 Referring to "DIMENSIONS" above, insert 2 supplied wood screws into the mounting wall for the left and right hangers. Allow about 1/4" space between the wall and screw-heads for hanging.

2. Range Hood Mounting

CAUTION: Wear working gloves to avoid injury.

- Detach the tape on the exhaust port.
- Detach the filters by loosening 2 screws. Remove 5 screws fixing the front cover and detach the front cover.

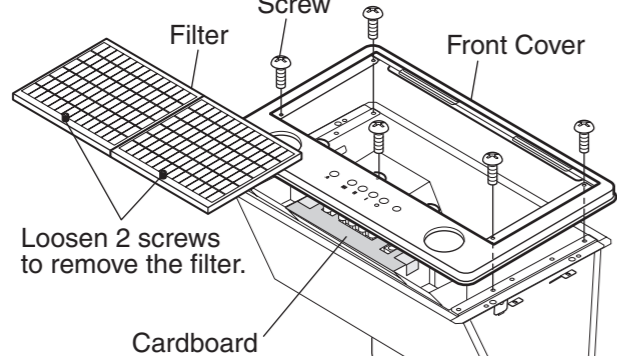

CAUTION: Do not remove the switch's protective cardboard until proceeding to "4. Final Assembly and Check".

3 Remove the fan unit from the range hood.

- Unplug the connector coming from the fan motor.
- Remove 3 screws, then detach the fan unit with sliding it laterally to disengage from 4 hooks.
- Pull up the fan unit while avoiding the bracket.

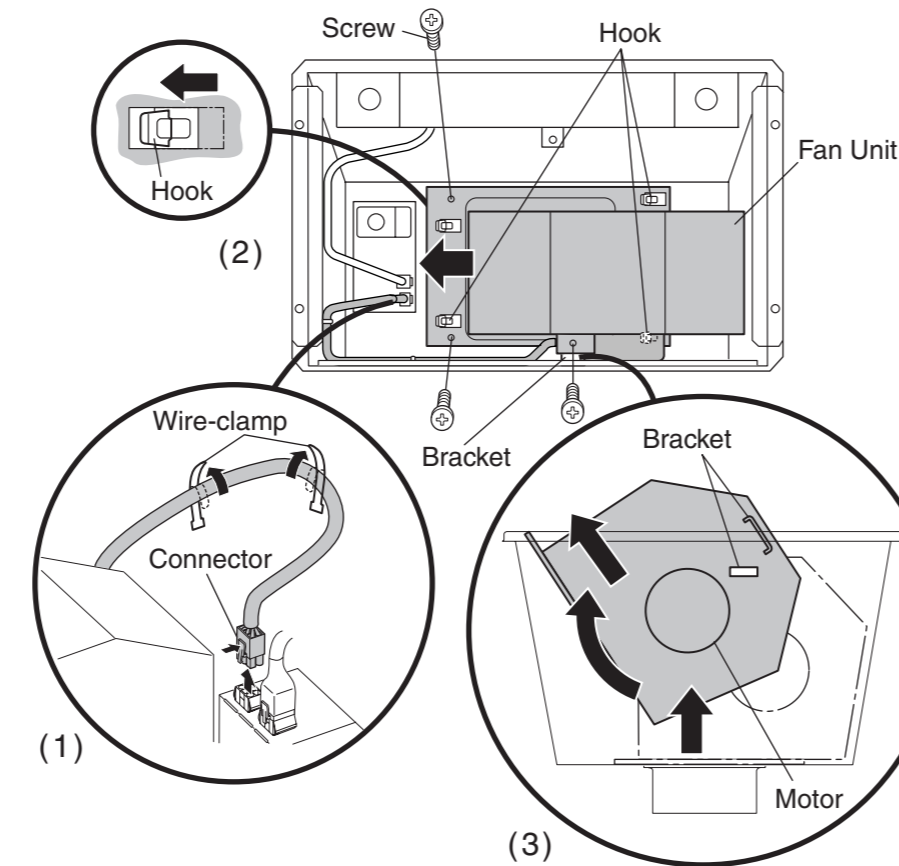

4 Hold up the range hood and align the 4 screw holes of the liner and range hood, then fix securely using the supplied screws (M5x30) and nuts. **Note:** Fasten all the screws and nuts evenly.

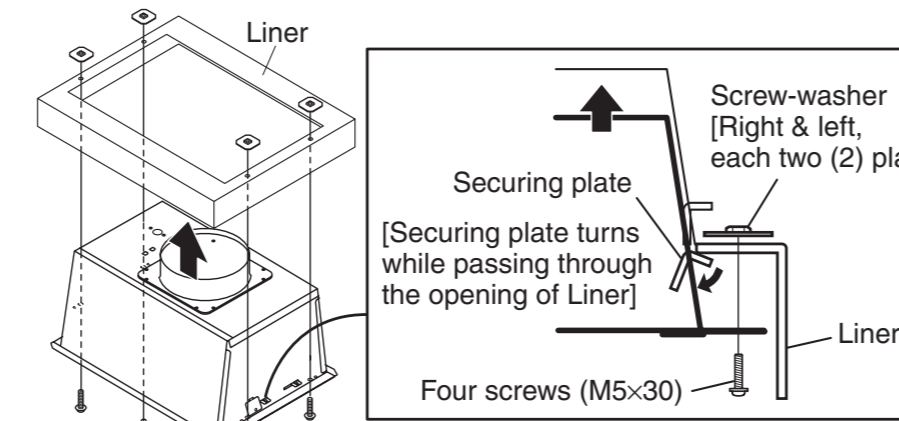

5 With inserting the exhaust port into the duct, hook both the left and right hangers on the screws provided in "Preparation" step 4.

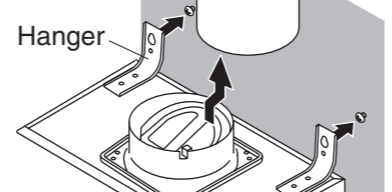

6 Tighten both the left and right screws, and fix the range hood securely adding 4 more supplied washer head wood screws to the holes on the hangers and back of the range hood.

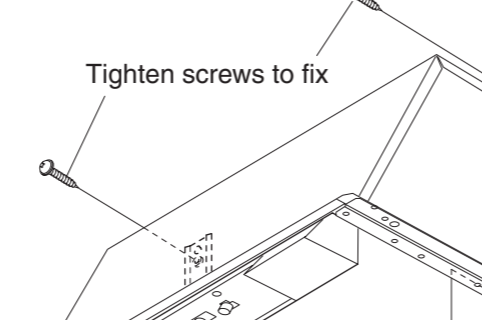

7 Make the duct joint secure and air-tight using non-flammable tape such as duct tape, etc. (Not supplied)

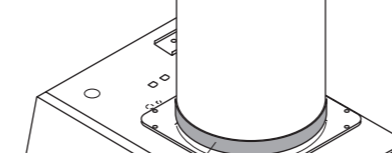

3. Connecting Power Supply Wires

WARNING: Electrical wiring should be done by a qualified person(s) in accordance with all applicable codes and standards, including fire-rated construction. An unqualified person doing the work could result in fire, electric shock or injury. This range hood uses 120V AC. Do not connect to other voltage since fire, electric shock or damage could result.

1 Remove the nut from the conduit connector at the end of power wiring.

WARNING: Be sure to switch power OFF at service panel before wiring.

2 Remove one screw fixing the wire cover and detach it.

3 Connect the conduit through the connecting hole of the body using the nut previously removed.

4 Connect wires tightly and securely using wire connectors (not supplied). Connect the electrical wires as follows:

- Black to Black
- White to White
- Green to Green

5 Replace the wire cover with the screw removed previously. Make sure that all wires are connected properly and enclosed inside of the wiring compartment.

4. Final Assembly and Check

Assembly
1 Attach the fan unit while avoiding the bracket, and fix it using 3 screws.

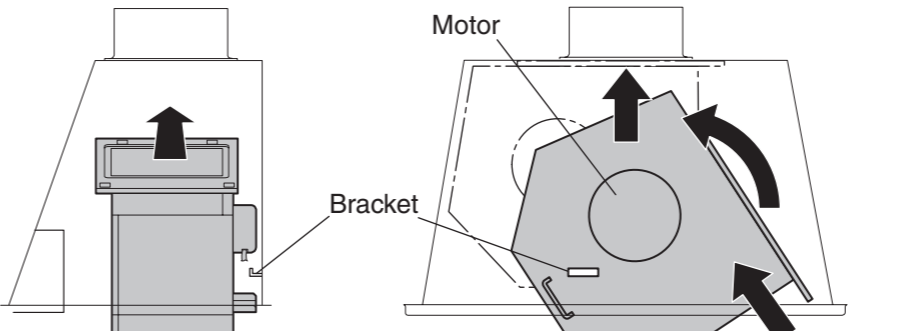

2 Connect the motor wire connector, and secure it with 2 wire-clamps.

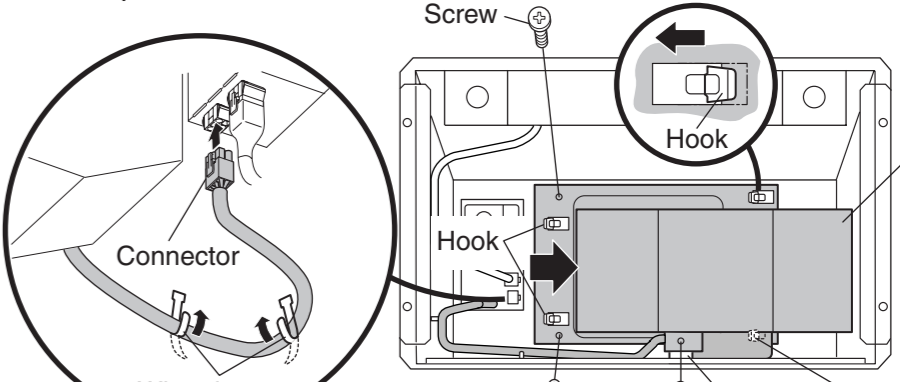

3 Remove the switch's protective cardboard.

WARNING: Remove the protective cardboard without fail, otherwise there is a risk of fire.

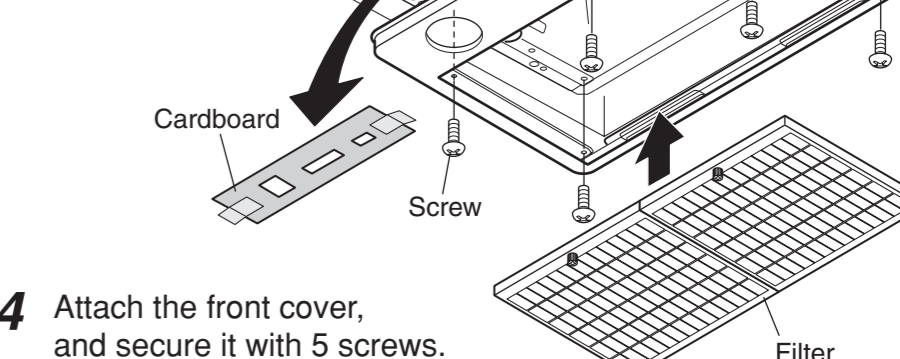

4 Attach the front cover, and secure it with 5 screws. Then attach the filters.

5 Two 50 Watt halogen light bulbs (not supplied) can be mounted in this range hood. Prior to function check, install light bulbs (PAR20 bulb, with base diameter 26 mm: medium base), rated 120 V - 50 Watt or below.

The following light bulbs are recommended for this range hood.

- GE Model No. 50PAR20H/FL25
- SYLVANIA Model No. 50PAR20/HAL/DL/NFL

Turn the lamps clock-wise to install them.

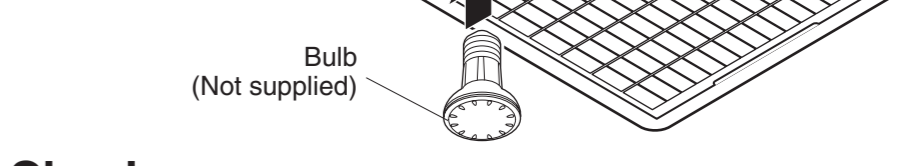

- Check**
- Turn on the electrical circuit to the range hood.
 - Make sure that the switches and light operate correctly. Refer to page 4 of the Operation Manual.
 - Make sure that the range hood functions properly and it has no abnormal noises and/or vibration.

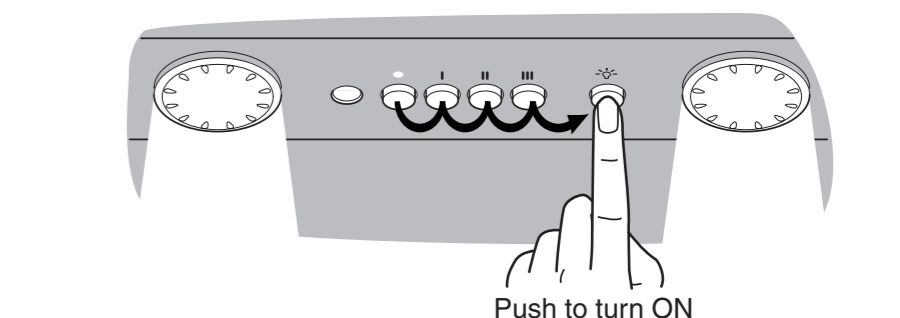

5. Explanation to the End User

- Referring to the Operation Manual, explain the operation of this range hood to end users.
- The Installation Manual and Operation Manual should be given to the end user.

